

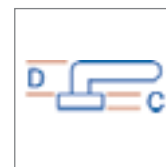

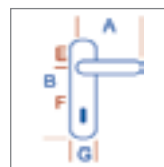



## TOPFORM *Exklusiv*

**Modell:** GOMERA  
**Artikel:** Schildgarnitur mit Rückholfeder, Garantie  
**Oberfläche:** Messing poliert/ Messing matt



A = 124,5 mm  
 B = 252,0 mm  
 E = 91,0 mm  
 F = 161,0 mm  
 G = 42,5 mm

C = 9,0 mm  
 D = 51,0 mm

| Ausführung | TOPFORM Artikel-Nr. | Preis Euro | EAN-Nummer   |
|------------|---------------------|------------|--|
| BB         | 024 517             | 44,75      | <br>4 048436 024517 |
| PZ         | 024 524             | 44,75      | <br>4 048436 024524 |
| BAD        | 024 531             | 60,75      | <br>4 048436 024531 |
| PZW rechts | 024 548             | 63,75      | <br>4 048436 024548 |
| PZW links  | 024 555             | 63,75      | <br>4 048436 024555 |

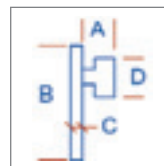

A = 63,0 mm  
 B = 252,0 mm  
 C = 9,0 mm  
 D = 50,5 mm



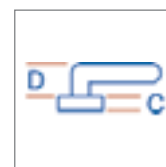
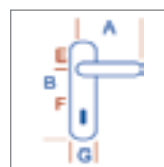

## TOPFORM *Exklusiv*

**Modell:** GOMERA  
**Artikel:** Renovierungsschildgarnitur mit Rückholfeder, Garantie  
**Oberfläche:** Messing poliert/ Messing matt



A = 125,0 mm  
 B = 249,0 mm  
 E = 93,5 mm  
 F = 155,0 mm  
 G = 46,5 mm

C = 9,85 mm  
 D = 55,0 mm

| Ausführung | TOPFORM Artikel-Nr. | Preis Euro | EAN-Nummer   |
|------------|---------------------|------------|--|
| BB         | 046 014             | 64,95      | <br>4 048436 046014 |
| PZ         | 046 021             | 64,95      | <br>4 048436 046021 |
| BAD        | 046 038             | 74,95      | <br>4 048436 046038 |
| PZW rechts | 046 045             | 76,95      | <br>4 048436 046045 |
| PZW links  | 046 052             | 76,95      | <br>4 048436 046052 |

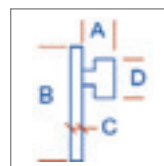

A = 62,5 mm  
 B = 249,0 mm  
 C = 9,85 mm  
 D = 50,5 mm