

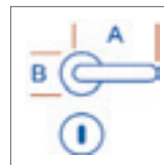





TOPFORM

Modell: PLUTO
Artikel: Rosettengarnitur, Clipsette mit Unter-
 konstruktion aus Kunststoff, mit Rückhol-
 feder und Stütznocken, Garantie
Oberfläche: Glanzchrom/ Edelstahl matt



A = 133,0 mm
 B = 52,0 mm

C = 11,0 mm
 D = 49,0 mm

Ausführung	TOPFORM Artikel-Nr.	Preis Euro	EAN-Nummer
BB	022 018	28,95	
PZ	022 025	28,95	
BAD	022 032	34,95	
PZW rechts	022 049	38,95	
PZW links	022 056	38,95	

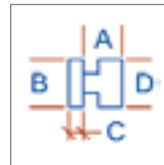

A = 48,2 mm
 B = 52,0 mm
 C = 11,0 mm
 D = 52,0 mm



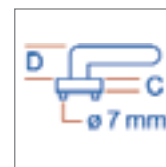
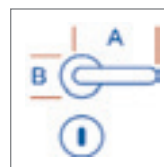

TOPFORM

Modell: ORION
Artikel: Rosettengarnitur, Clipsette mit Unter-
 konstruktion aus Kunststoff, mit Rückhol-
 feder und Stütznocken, Garantie
Oberfläche: Glanzchrom/ Edelstahl matt



A = 130,0 mm
 B = 52,0 mm

C = 11,0 mm
 D = 60,0 mm

Ausführung	TOPFORM Artikel-Nr.	Preis Euro	EAN-Nummer
BB	022 513	28,95	
PZ	022 520	28,95	
BAD	022 537	34,95	
PZW	022 544	38,95	

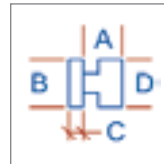

A = 48,2 mm
 B = 52,0 mm
 C = 11,0 mm
 D = 52,0 mm



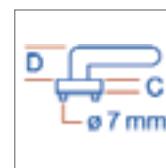
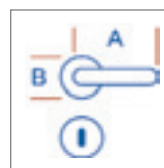

TOPFORM

Modell: URANUS
Artikel: Rosettengarnitur, Clipsette mit Unter-
 konstruktion aus Kunststoff, mit Rückhol-
 feder und Stütznocken, Garantie
Oberfläche: Glanzchrom/ Edelstahl matt



A = 128,0 mm
 B = 52,0 mm

C = 11,0 mm
 D = 50,0 mm

Ausführung	TOPFORM Artikel-Nr.	Preis Euro	EAN-Nummer
BB	023 015	28,95	
PZ	023 022	28,95	
BAD	023 039	34,95	
PZW	023 046	38,95	

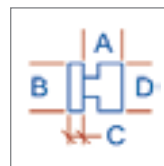

A = 48,2 mm
 B = 52,0 mm
 C = 11,0 mm
 D = 52,0 mm